



MYANMAR RIVER JOURNEYS

SHORT CRUISES (1-3 NIGHTS) | DISCOVERY CRUISES (7-10 NIGHTS)

by

RV  PAUKAN 2007 & RV  PAUKAN 2012

2018 - 2020 BROCHURE

WWW.AYRAVATACRUISES.COM



Paukan Cruises

SINCE 2003

by Ayravata Cruise Company



EXPERIENCE
THE WORLD OF

RV PAUKAN
2 0 0 7
A Charming Cruising Boutique Hotel

RV PAUKAN
2 0 1 2
A Small Cruising Boutique Hotel





Dear Travel Partner,

There is no better way to experience the wonder and mystery that is Myanmar than from the Irrawaddy River, and there is no better time to visit than now.

As the country continues to evolve as a result of opening its doors to the west, the opportunity to visit a country virtually frozen in time for decades creates the most unique and unforgettable journey.

From the bustling former capital of Yangon (Rangoon) filled with the excitement of what Myanmar's future holds, to the rural areas where ox carts are still the local mode of transportation – you will find no greater contrast anywhere in the world.

Guests will find themselves immersed in the rich history of once British colonial "Burma", and a rich culture of unique indigenous tribes found throughout the country.

All of this is witnessed from the most luxurious river cruiser to ply the Irrawaddy. Paukan Cruises invites you to join us on this truly once in a lifetime journey.

Welcome Aboard!



Paukan Cruises is very proud to introduce the RV PAUKAN 2007 and the RV PAUKAN 2012 Launched in 2007 and 2012 respectively they are the first of four new vessels in our fleet to ply the rivers of Myanmar

The 55-guest Paukan 2007 and 34-guest Paukan 2012 the embrace the ambience of modern Asian design, whilst providing comforts and conveniences found only in the finest hotels of Myanmar



THE RV PAUKAN 2007





AIR-CONDITIONED SALOON BAR





DINING ROOM







G A S T R O N O M Y

Our chef has innovatively created a menu which highlights the diverse cuisine of Myanmar, as well as Western favorites that will be reflected in sumptuous buffets and artfully prepared, multi-course dinners.

The culinary team will offer an occasional shopping excursion to local markets taking every opportunity to utilize the fresh, local fruits and vegetables throughout the voyage.





OUTDOOR BAR & AL-FRESCO LOUNGE





UPPER DECK SUITE





UPPER DECK DELUXE DOUBLE & TWIN



MAIN DECK TWIN & LOWER DECK SINGLE

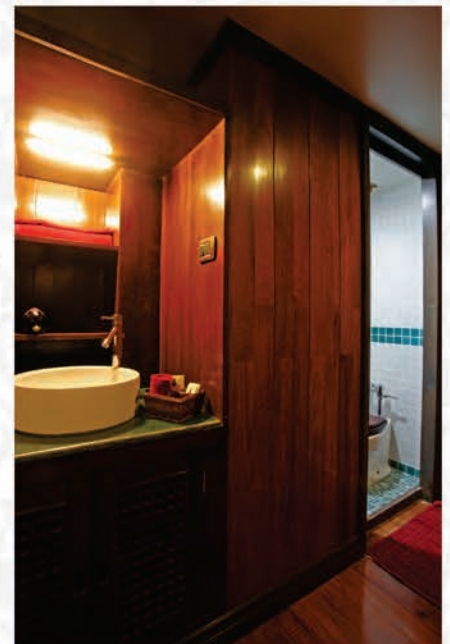

ACCOMMODATION

Accommodations aboard the RV Paukan 2007 embody the grace and style of modern Asian design, incorporating conveniences and luxuries that rival the finest hotels of Asia. Spacious, well appointed suites provide individual climate control, flat-screen television, spa quality robes, slippers and bath amenities, daily housekeeping with turndown service, fine bed linens, premium mattresses, duvets, your choice of pillows, and daily, international news.

UPPER DECK SUITE

430 Square Feet/40 Square Meters

- Floor-to-ceiling French doors with balcony providing panoramic river views.
- Seating area
- Twin beds or king-size bed
- Writing desk
- Spacious bath with rain-style shower



UPPER DECK DELUXE DOUBLE

226 Square Feet/21 Square Meters

- Floor-to-ceiling French doors with providing panoramic river views.
- Seating area
- Double bed
- Writing desk
- Spacious bath with rain-style shower



UPPER DECK DELUXE TWIN

226 Square Feet/21 Square Meters

- Floor-to-ceiling French doors with providing panoramic river views.
- Seating area
- Twin Beds or queen-size bed
- Writing desk
- Spacious bath with rain-style shower



MAIN DECK SUPERIOR TWIN

161 Square Feet/15 Square Meters

- Floor-to-ceiling doors with providing panoramic river views.
- Seating area
- Twin beds or queen-size bed
- Writing desk
- Spacious bath with rain-style shower



LOWER DECK SINGLE

107 Square Feet/10 Square Meters

- Window river views.
- Seating area
- Single bed
- Writing desk
- Spacious bath with rain-style shower





ELEVATION

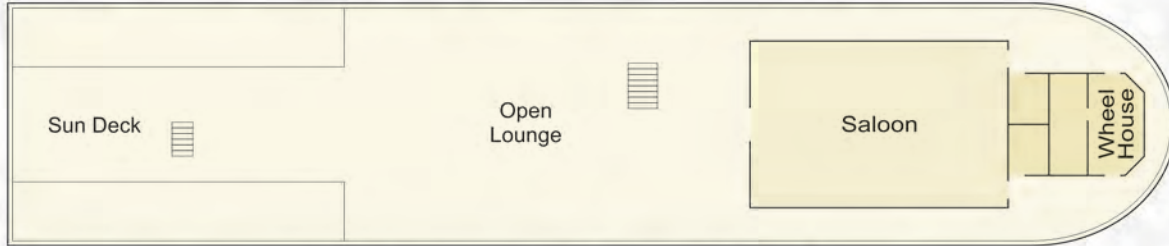

SUN DECK



UPPER DECK

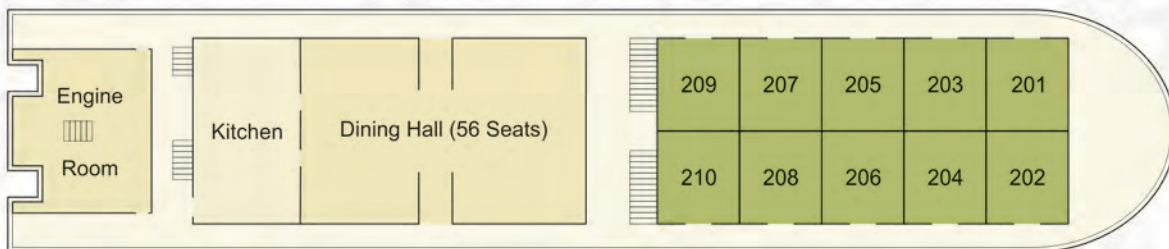

MAIN DECK

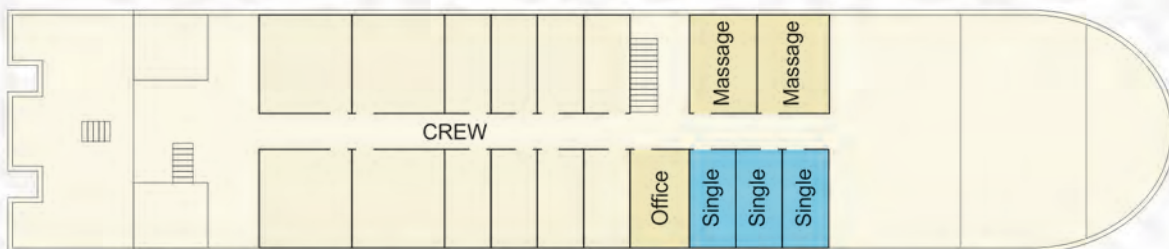

LOWER DECK

SHIP SPECIFICATIONS:

Length: 200 Feet/61Meters
 Beam: 38 Feet/11.58 Meters
 Draft: 3.09 Feet/1.14 Meters
 Total Suites/Capacity: 29 Cabins/55 Passengers

- Upper Deck Cabins
- Upper Deck Suites
- Main Deck Cabins
- Lower Deck Single Cabins

THE RV PAUKAN 2012





INDOOR LOUNGE





DINING ROOM







G A S T R O N O M Y

Our chef has innovatively created a menu which highlights the diverse cuisine of Myanmar, as well as Western favorites that will be reflected in sumptuous buffets and artfully prepared, multi-course dinners.

The culinary team will offer an occasional shopping excursion to local markets taking every opportunity to utilize the fresh, local fruits and vegetables throughout the voyage.





OPEN SUN LOUNGE & OUTDOOR BAR





PREMIER





UPPER DECK DOUBLE & MAIN DECK TWIN & SINGLE





ACCOMMODATION

Accommodations aboard the RV Paukan 2012 embody the grace and style of modern Asian design, incorporating conveniences and luxuries that rival the finest hotels of Asia. Spacious, well appointed suites provide individual climate control, flat-screen television, spa quality robes, slippers and bath amenities, daily housekeeping with turndown service, fine bed linens, premium mattresses, duvets, your choice of pillows, and daily, international news.

UPPER DECK PREMIER

270 Square Feet/25 Square Meters

- Floor-to-ceiling French doors with Balcony providing panoramic river views.
- Seating area
- Twin beds or King-size bed
- Writing desk
- Spacious bath with rain-style shower

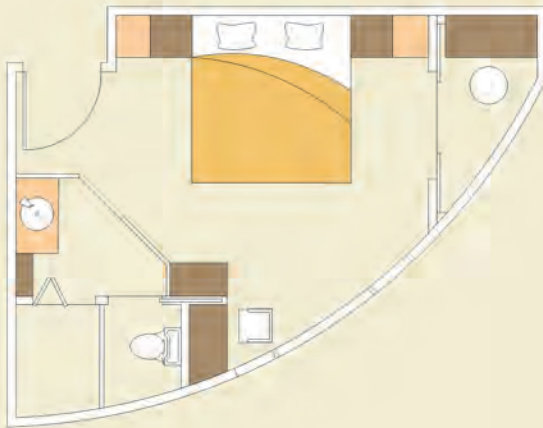

UPPER DECK DELUXE DOUBLE

270 Square Feet/25 Square Meters

- Floor-to-ceiling glass doors with Balcony providing panoramic river views.
- Seating area
- Double bed
- Writing desk
- Spacious bath with rain-style shower



UPPER DECK DELUXE TWIN

270 Square Feet/25 Square Meters

- Floor-to-ceiling glass doors with Balcony providing panoramic river views.
- Seating area
- Double bed
- Writing desk
- Spacious bath with rain-style shower



MAIN DECK DELUXE TWIN

250 Square Feet/23 Square Meters

- Floor-to-ceiling glass doors with Panoramic river views.
- Seating area
- Twin beds or queen-size bed
- Writing desk
- Spacious bath with rain-style shower



UPPER DECK SINGLE

107 Square Feet/10 Square Meters

- Glass window with panoramic river views.
- Seating area
- Single bed
- Writing desk
- Spacious bath with rain-style shower



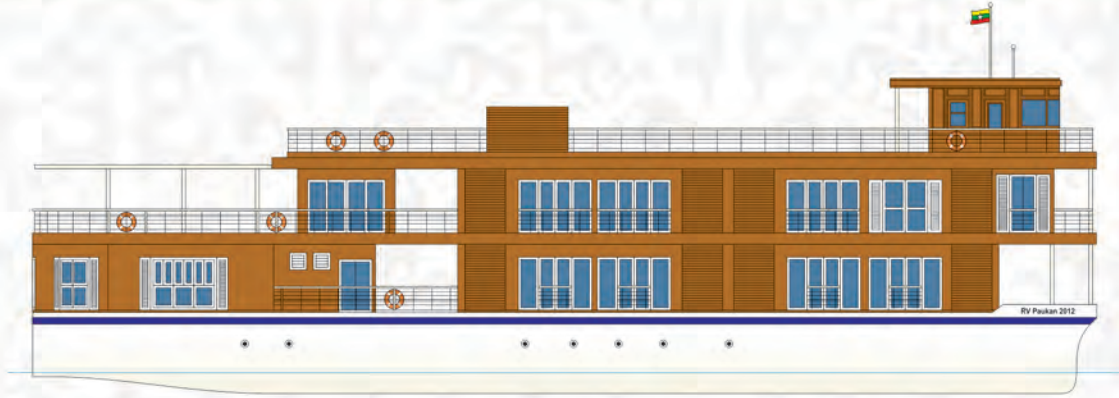

ELEVATION

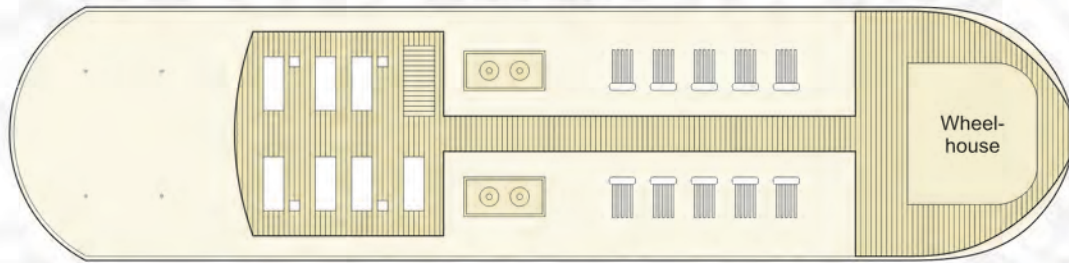

SUN DECK

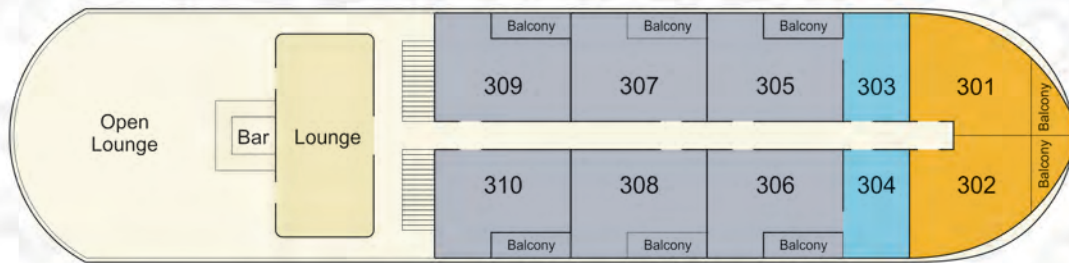

UPPER DECK

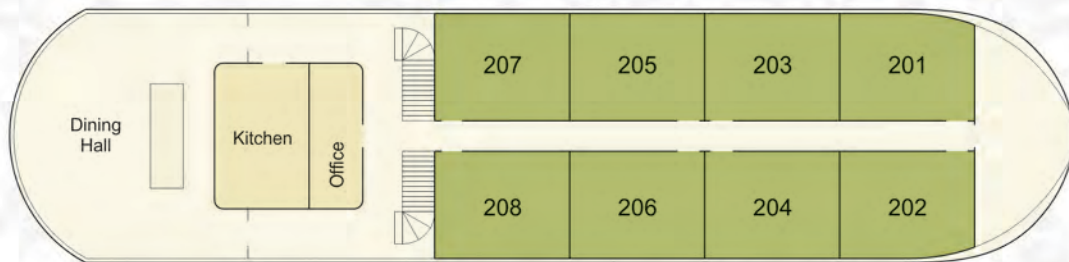

MAIN DECK

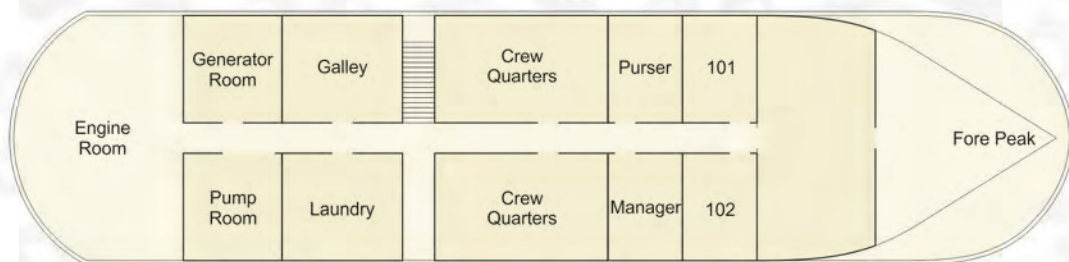

BELOW MAIN DECK

SHIP SPECIFICATIONS:

Length: 200 Feet/61Meters
 Beam: 42 Feet/12.8 Meters
 Draft: 3.9 Feet/1.2 Meters
 Total Suites/Capacity: 18 Suites/36Passengers

- Upper Deck Cabins
- Upper Deck Premier Cabins
- Main Deck Cabins
- Upper Deck Single Cabins



LIFE ON BOARD OF RV PAUKAN 2007

ROOM AMENITIES

- Spacious rooms
- Upper deck deluxe 226 square Feet
- Upper deck suite bow 430 square Feet
- Main deck superior twin 170 square Feet
- Lower deck single for guest 107 square Feet
- Lower deck single for guide 86 square Feet
- Well trained spa therapists will serve you different selection of treatments
- Daily promotion and special rate for birthday and anniversary
- In-room electronic safe
- Individual climate control
- Egyptian super-combed cotton linens, blankets and
- European-style duvets
- Premium mattress
- Bottled water, replenished daily
- Library
- Souvenirs shop
- Wireless internet in all public areas
- Make-up mirror
- Multi-configuration plugs
- Generous closet space
- Soft and firm pillows
- Nightly turndown service
- Wall to wall panoramic window (Upper deck deluxe only)
- Private bathroom full shower with glass door and hairdryer
- Bathrobes, premium bath amenities and in house slippers
- Every under-bed luggage storage
- Writing desk with mirror, comfortable chair and table with reading lamps

COMPLIMENTARY ON EXCURSIONS:

- Shore Excursion Program Series including all admissions
- Shoe cleaning after excursions
- Welcome drink following excursions
- VOX listening devices for duration of cruise program
- Face mask, cold towel and insect repellent to be supplied if needed
- 36 guests per guide on all excursions

LOUNGE, DINING & ENTERTAINMENT:

- Expertly trained culinary staff providing buffet breakfast, buffet lunch and seated dinner in one single seating
- Complimentary coffee, water and tea only for short cruise
- Complimentary coffee, water, tea, soft drinks, local beer and free flow house wine (wine with dinner only) for long cruise
- Series of cultural performances, educational talks, cooking classes and ship tour
- Welcome reception
- Farewell reception
- Theme dinners
- Spacious air conditioned lounge with nightly entertainment
- Dining room capacity 56 seats
- Massage room
- Lectures room Fully equipped with LCD projector (56 seats)

YOUR PAUKAN 2007 TEAM ABOARD

(providing a better than 2 to 1, crew to passenger ratio)

- Captain
- First Officer
- Second Officer
- Chief Engineer + Asst C E
- Manager 2 staff
- Electrical Officer + Asst E O
- Nautical - 5 staff + 1 staff cook
- Housekeeping - 5 Staff
- Dining - 4 staff
- Galley - 7 staff
- Spa - 2 staff
- Bar - 2 staff
- Resident local 1 guide
- Accommodation for Tour Manager



LIFE ON BOARD OF RV PAUKAN 2012

ROOM AMENITIES

- Spacious rooms
- Upper Deck Double Deluxe with Balcony 270 square feet
- Upper Deck Premier with Balcony 270 square feet
- Upper Deck Single 107 square feet
- Main Deck Twin Deluxe with French Balcony 250 square feet
- Lower Deck Single for Guide 86 square feet
- In-room electronic safe
- Individual climate control
- Egyptian super-combed cotton linens, blankets and European-style duvets
- Premium mattress
- Bottled water, replenished daily
- Library
- Souvenirs shop
- Wireless internet in all public areas
- Make-up mirror
- Multi-configuration plugs
- Generous closet space
- Projector Screen for Nightly Entertainment Movie in the Lounge
- Soft and firm pillows
- Nightly turndown service
- Wall to wall panoramic window
- Private bathroom full shower with glass door and hairdryer
- Bathrobes, premium bath amenities and in-house slippers
- Luggage Rack
- Writing desk with mirror, comfortable chair and table with reading lamps

COMPLIMENTARY ON EXCURSIONS:

- Shore Excursion Program Series including all admissions
- Shoe cleaning after excursions
- Welcome drink following excursions
- VOX listening devices for duration of cruise program
- Face mask, cold towel and insect repellent to be supplied if needed
- 36 guests per guide on all excursions

LOUNGE, DINING & ENTERTAINMENT:

- Expertly trained culinary staff providing buffet breakfast, buffet lunch and seated dinner in one single seating
- Complimentary coffee, water, tea soft drinks, local beer and free flow house wine (wine with dinner only) for long cruise
- Complimentary Coffee, Tea and water only for short cruise
- Series of cultural performances, educational talks, cooking classes and ship tour
- Welcome reception
- Farewell reception
- Theme dinners
- Spacious air conditioned lounge with nightly entertainment

YOUR PAUKAN 2012 TEAM ABOARD

(providing a better than 2 to 1, crew to passenger ratio)

- Captain
- First Officer
- Second Officer
- Chief Engineer -2 Staff
- Manager- 2 staff
- Electrical Officer
- Nautical – 5 staff + 1 staff cook
- Housekeeping - 4 Staff
- Dining - 3 staff
- Galley – 5 staff
- Bar – 2 staff
- Resident local 1 guide
- Accommodation for Tour Manager



MYANMAR HERITAGE (7N)

DAY 1 BAGAN (EMBARKATION) – SALAY (LUNCH/DINNER/WELCOME RECEPTION)

EMBARKATION

Board the Ship at Ayeyar Jetty 11:00 am and cast off 11:30 am, welcome cocktail in the saloon.

AFTERNOON EXCURSION: Salay

After Lunch, we walk ashore at Salay, a small town founded in the 13th century with Bagan-era shrines, beautiful 19th century teak monasteries and preserved British colonial buildings. We explore the Salay House, a restored 1906 colonial trading company warehouse on the bank of the Irrawaddy. Our walk takes us along the town's main Strand Street towards the local market before visiting the beautiful Yoke Soun Kyaung Taw Gyi wooden monastery. This ornately carved teak monastery was designed as a copy of the Crown Prince House of Mandalay, and is now a museum boasting remarkable wood carvings and artifacts. We pass some interesting Bagan-era monuments on our way to visit Mann Paya, a pagoda with a beautiful lacquerware Buddha, before returning to our ship. Dinner and moor overnight mid stream.

DAY 2 BAGAN (BREAKFAST/LUNCH/DINNER)

MORNING EXCURSION: Bagan

This morning our excursion takes us to one of the most incredible areas of Myanmar: Bagan. Once the center of the Pagan Empire, Bagan today is a tourist, artist, and archeological mecca. We will start the tour with Shwezigon Pagoda constructed during the reign of King Anawrahta and a Buddhist religious place. It is believed to enshrine a bone and tooth of Gautama Buddha. Then we proceed to the massive Htilominlo temple, built by King Htilominlo on the site where he was chosen to be the crown prince of Pagan. Htilominlo boasts the finest plaster carvings which still remain undamaged on the arch pediments. Then we stop by Thatbyinnyu Pagoda for photo shoot on the way back to ship for Lunch.

AFTERNOON EXCURSION: Bagan

After lunch, we visit Gubyaukgyi Temple, where the richly-colored paintings are thought to date to the early 12th century and we will also see a sand painting demonstration by a local artist. Next to this temple is the gilded Myazedi Stupa, which offers both a linguistic and a historical significance: an inscription consecrating Gubyaukgyi in four languages (Pyu, Mon, Old Burmese, and Pali), which established Pyu as an important cultural influence in the early Pagan period. A visit to Bagan would not be complete without exploring the famous Ananda temple. Built in 1105 CE during King Kyanzittha's reign, it is one of only four surviving temples

from this period. We will explore the cruciform of the temple, with four standing Buddhas facing north, south, east, and west. After that we stop by Dhammayan Gyi Pagoda for photo shoot. For our final stop of the day we proceed to the Bagan Viewing Hill where we will view the sunset over the pagodas and stupas of Bagan before returning to the ship.

DAY 3 BAGAN-RIVER VILLAGE (BREAKFAST/LUNCH/DINNER)

MORNING EXCURSION: Bagan

Explore some of Bagan's local markets selling wood carvings, fabric, longyis and rattan product. Visit a workshop to see the ancient technique of lacquer ware making. Alternatively, guests can hire a horse cart or a bicycle and explore the site on their own (or) have a splendid Balloon Flight over Bagan (surcharge applied – optional). Back to the ship around Noon and cast off.

AFTERNOON EXCURSION: River Village

We cruise upstream all day. Stop at River village for a walk. Dinner followed by a Puppet Show on the sundeck.

DAY 4 YANDABO (BREAKFAST/LUNCH/DINNER)

MORNING EXCURSION: Yandabo

In the morning we arrive at Yandabo, a picturesque river village specializing in Pot-Making, where the peace treaty of the First Anglo-Burmese war signed on Feb. 24, 1826. We go ashore for a walking at some pot-making workshops and visit the monastery.

We cruise upstream the rest of the day, moor overnight near Myin Mu.

DAY 5 MONYWA (BREAKFAST/LUNCH/DINNER)

FULL DAY EXCURSION: Monywa

Early morning drive by coach (approx. 1 ½ hours) to Monywa to visit the Hpowindaung cave where hundreds of Buddha Statues are placed inside niches decorated with wonderful mural paintings. Serve Lunch at local restaurant in Win Unity Hotel in Monywa. After lunch we visit the splendid Sambuddhai Kat Kyaw pagoda with its more than 500,000 Buddha images.

Drive back to Myin Mu and Overnight night at River bank.

DAY 6 AVA – SAGAING - AVA

(BREAKFAST/LUNCH/DINNER)

MORNING EXCURSION: Ava

Visit Ava by horse-cart visiting the beautiful 200 year old teak Bagaya Kyaung Monastery, Nanmyin watchtower (27mt. high) and the Me Nu Ok Kyaung monastery. Return to ship & sailing to Sagaing.

AFTERNOON EXCURSION: Sagaing – Amarapura

In the afternoon, we visit to Sagaing Hill, a hill studded with many Pagodas and Monasteries rich in wood carving and religious art. Then we travel by coach to Amarapura, the penultimate Burmese Royal Capital (1783) to visit a traditional silk weaving workshop followed by U-Bein Bridge, the world's longest wooden bridge (1.2 km) and enjoy the sunset there. Dinner and overnight on board near Sagaing Hill.

DAY 7 MINGUN – CENTRAL MANDALAY

(BREAKFAST/LUNCH/FAREWELL DINNER)

MORNING EXCURSION: Mingun

After breakfast we will enjoy a leisurely walking tour of the small town of Mingun. Our first stop is King Bodawpaya's monumental, uncompleted

stupa. During construction, an astrologer to the king argued that the king would die upon completion of the temple, and work was immediately halted. Had it been completed, it would have been the largest in the world. The cracks we see are the result of the 23 March 1839 earthquake that shook the area. We continue our walk to the Mingun Bell, which was the heaviest working bell in the world until 2000 when the Bell of Good Luck was unveiled in Henan, China. After having the opportunity to stand inside the bell as it is rung, we have time to shop in the local market, famous for its makeshift galleries that display inexpensive art from both local and internationally known artists. Lunch on board.

AFTERNOON: Central Mandalay

Visit central Mandalay: Mahamuni Pagoda, then visit to the workshops of gold leaf making and marble carving. And visit to Kuthodaw Paya, which contains the world's biggest book, near by Mandalay Hill where spiraling staircases lead to sweeping views of the city and its temples and Sunset time at Mandalay Hill. Dinner on board. Overnight at Mandalay.

DAY 8 MANDALAY (DISEMBARK)

(BREAKFAST)

Morning disembark at Gawein Jetty around 9:00 am.

ROYAL MYANMAR (3N)

DAY 1 BAGAN (Embarkation) - RIVER VILLAGE

(LUNCH/DINNER/WELCOME RECEPTION)

EMBARKATION

Board the ship at Aye Yar Jetty in Bagan at 10:30 AM and cast off 11:00 AM. Welcome cocktail and Lunch.

AFTERNOON EXCURSION: Salay

We cruise upstream all day. Stop at River village for a walk. Dinner followed by a Puppet Show on the sundeck.

DAY 2 YANDABO

(BREAKFAST/LUNCH/DINNER)

MORNING EXCURSION: Yandabo

In the morning we arrive at Yandabo, a picturesque river village specializing in Pot-Making, where the peace treaty of the First Anglo-Burmese war signed on Feb. 24, 1826. We go ashore for a walking at some pot-making workshops and visit the monastery. We cruise upstream the rest of the day, moor overnight near Myin Mu.

DAY 3 BAGAN - RIVER VILLAGE

(BREAKFAST/LUNCH/DINNER)

FULL DAY EXCURSION: Monywa

Early morning drive by coach (approx. 1 ½ hours) to Monywa to visit the Hpowindaung cave where hundreds of Buddha Statues are placed inside niches decorated with wonderful mural paintings dated back. Serve Lunch at local restaurant in Win Unity Hotel in Monywa. After lunch we visit the splendid Sambuddhai Kat Kyaw pagoda with its more than 500,000 Buddha images.

Drive back to Myin Mu and Overnight night at river bank.



DAY 4 AVA - SAGAING (Disembarkation)

(BREAKFAST/LUNCH)

MORNING EXCURSION: Ava

Visit Ava by horse-cart visiting the beautiful 200 year old teak Bagaya Kyaung Monastery, Nanmyin watchtower (27mt. high) and the Me Nu Ok Kyaung monastery. Return to ship & sailing to Sagaing.

DISEMBARKATION: Sagaing

Guest will disembark 12:30 PM at Sagaing Jetty.



FROM ROYAL MANDALAY TO ANCIENT BAGAN (2N)

DAY 1 MANDALAY (GAWEIN) – MINGUN (LUNCH/DINNER/WELCOME RECEPTION)

EMBARKATION

The embarkation time is 12.00 noon at Gawein jetty and cast off after half an hour time.

Welcome Cocktail and briefing in the Saloon or Sundeck followed by Lunch.

After cruising upstream for two hours we arrive at Mingun where we visit the impressive unfinished pagoda and the largest working bell in the world. Our English speaking manager (or your private guide) will accompany the guests during the visit.

Moor Overnight at a sandbank mid-stream. After dinner guests can enjoy a Dance and Drama performance by the Mandalay Arts School on the sundeck (if available).



DAY 2 MINGUN – SAGAING –YANDABO (BREAKFAST/LUNCH/DINNER)

MORNING EXCURSION: Sagaing

Early in the morning cruise downstream. During the two hours journey the passengers can admire the natural beauty of the river and the life of its banks while relaxing on the sundeck or just sitting outside their own cabin. Enjoy the sunrise over Sagaing Hill.

After breakfast passengers wishing to visit Sagaing can go ashore with the assistance of our Ship Manager or their own guide.

We resume our downriver voyage at 10.30 hrs and we will sail all day long.

AFTERNOON EXCURSION: Yandabo

we stop at Yandabo, a village specializing in Pot-Making, where the peace treaty of the First Anglo-Burmese war was signed on Feb. 24, 1826. We visit the Pot workshops, the monastery.

Moor overnight near the village of Shwe Nann Tint.

DAY 3 BAGAN (BREAKFAST)

Cast off early in the morning for the last leg of our journey. Enjoy the sunrise near Bagan. Passengers will disembark at Aye Yar jetty around 9:30 hrs.

BETWEEN ANCIENT BAGAN & ROYAL MANDALAY (2N)

DAY 1 BAGAN – CRUISING TO MANDALAY (RIVER VILLAGE STOP) (LUNCH/DINNER/WELCOME RECEPTION)

EMBARKATION

The embarkation time is 11.30 hrs at Bagan Aye Yar jetty and cast off after half an hour.

Welcome Cocktail and briefing in the Saloon or Sundeck followed by Lunch.

AFTERNOON EXCURSION: River Village

In the late afternoon stop in a typical river village.

DAY 2 CRUISING TO MANDALAY (VISIT YANDABO VILLAGE) (BREAKFAST/LUNCH/DINNER)

MORNING EXCURSION: Yandabo

Cruise all day with stop enroute in the morning to visit Yandabo, a typical river village specializing in Pot-Making, where the peace treaty of the First Anglo-Burmese war was signed on Feb. 24, 1826. We visit the Pot workshops, the monastery.

Moor overnight nearby a village (Ywar Thit Gyi or Pauk Myaing Pauk Taw) few miles away from Ava Bridge.

DAY 3 BAGAN (BREAKFAST)

Enjoy the sunrise. After an early breakfast, the passengers will disembark at Sagaing Jetty (Thursday only) or Gawein jetty (Sunday Only) at around 09.30hrs.



BETWEEN ROYAL MANDALAY & ANCIENT BAGAN (1N)

DAY 1 MANDALAY (SAGAING) – YANDABO (LUNCH/DINNER/WELCOME RECEPTION)

The embarkation time is 10.00 hrs at SAGAING jetty and cast off after half an hour.

Welcome Cocktail and briefing in the Saloon or Sundeck followed by lunch.

Cruise all day long. In the late afternoon we stop at Yandabo, a village specializing in Pot-Making, where the peace treaty of the First Anglo-Burmese war was signed on Feb. 24, 1826. We visit the Pot workshops, the monastery.

Moor overnight near the village of Shwe Nann Tint.



DAY 2 BAGAN (BREAKFAST/LUNCH/DINNER)

Early in the morning we continue downstream to Bagan. After breakfast (if time permits) we visit another typical river village. Enjoy the sunrise near Bagan. Passengers will disembark at Bagan Aye Yar jetty by 9:30 hrs.



EXPEDITION CRUISES



DAY 1 BAGAN – PAKKOKU (LUNCH/DINNER/WELCOME RECEPTION)

Board the ship at 09.00 hrs. We cast off at 09.30 hrs and sail upstream to the Irrawaddy and the Chindwin confluence. If time permits we stop in Thein Gone, a typical river village where we visit the school and the monastery. We continue cruising north to the bustling town of Pakkoku where we visit the monastery, cheroots and weaving workshops. We pass the Chindwin and Irrawaddy river confluence and we stop for the night.

DAY 2 PAKKOKU - PAKHAN-GYI - AHMYINT – MONYWA (BREAKFAST/LUNCH/DINNER)

Visit the little town of Pakhan-gyi. This post-Pagan period provincial capital was walled with a moat and originally had a governor's palace. We see the old walls; visit the museum and a spectacular 19th century wood carved monastery. We continue cruising to Ahmyint village and visit the local market, where we can see beautiful houses and the lovely 17th century style Min Kyaw Swa stupas with 18th century style paintings. Arrive at Monywa, the Chindwin River largest port, in the early evening.

DAY 3 MONYWA (HPOWINDAUNG CAVES) (BREAKFAST/LUNCH/DINNER)

We visit Hpowindaung Caves where hundreds of Buddha Statues are placed inside niches decorated with wonderful mural paintings. Late lunch and cast off.

DAY 4 KANI (BREAKFAST/LUNCH/DINNER)

Late morning explore the village of Kanee and climb the pagoda hillock for its view. We continue sailing upstream until late at night to reach the village of Kani.

DAY 5 KIN – MINGIN (BREAKFAST/LUNCH/DINNER)

Early morning we explore Kin village with its beautiful wooden houses and the woodcarvings monastery. Continue sailing upstream to the small enchanting town of Mingin. Explore its temples and 1900's wooden houses and the Min Kyaung Monastery with old Buddha Images.



DAY 6 KYIDAW

(BREAKFAST/LUNCH/DINNER)

At Kyidaw (Kyi Taung Oo) we visit Shwe Za War Yaw monastery one of the oldest and best preserved wood carved monastery of Myanmar, embellished with wooden sculpted idols with fascinating gold leaf wall decorations. We walk through a beautiful scenario of paddy fields to the village of Kan where we visit another splendid example of Myanmar old monastery. Afterwards we return to the ship by local boat.

Proceed upstream up to Kyaw Zin, a village very close to Kalewa, where we stop for the night.

DAY 7 KALEWA

(BREAKFAST/LUNCH/DINNER)

In the morning we explore Kalewa, the main river port for the trading with India, the lively market and climb up to Shwe Moat Htw stupa for the beautiful view.

Back to the ship before lunch and keep on cruising upstream to Mawlaik.



DAY 8 MAWLAIK – SAILING BACK DOWNSTREAM

(BREAKFAST/LUNCH/DINNER)

Mawlaik (situated 35 km from the Indian Border) was the administrative capital of this area rich of Teak forests. It is a pleasant colonial town with its golf course surrounded by splendid colonial houses built by the Bombay Burmah Trading Corporation in the 1920's and 1930's (there is still a small community of Indians that used to work for the Scottish company and their descendents). The governor's house, the administrative building, the school, the hospital, the "Dak Bungalows", company headquarter are well preserved, still in use nowadays and nicely maintained.

Being this our turnaround point, we begin sailing back downstream to Monywa.

DAY 9 SAILING DOWNSTREAM FOR 100 MILES

(BREAKFAST/LUNCH/DINNER)

Continue sailing all day downstream. Stop at a typical River village, famous for its Petrified Wood, where we visit the school and the typical houses.



DAY 10 YANDABO

(BREAKFAST/LUNCH/DINNER)

In the morning stop at Yandabo, a picturesque river village specializing in Pot-Making, where the peace treaty of the First Anglo-Burmese war signed on Feb. 24, 1826. Explore the village stopping to some pot-making workshops to learn their unique production technique, and visit the monastery. Back to the ship for Lunch and sail all day.



DAY 11 MANDALAY (DISEMBARKATION)

(BREAKFAST)

After breakfast, the client disembark at Gawein Jetty around 9:00 am.



RIVERS OF MYANMAR

Experience the rich history and diverse culture of the Irrawaddy River and the Chindwin River.

This incredible journey transports you through areas of Myanmar rarely visited by westerners and many not accessible other than by river. Every port will tell a story from the more than 2200 intricately carved temples to the handmade pottery made in the village of Yandabo and floated down the Irrawaddy has it has been for hundreds of years, this experience is like no other you've experienced.

When paired with our optional pre and post cruise extension programs, our itineraries create a wonderful in-depth perspective to a country that is now entering a never before seen transformation.



DISCOVER MORE WITH PAUKAN CRUISES

PRE & POST CRUISE EXTENSION PROGRAMS



MYANMAR HERITAGE (7N)

Pre: Yangon package (1N/2D) From US\$ 375 per person

RANGOON (YANGON) (L/D)

International arrival to Yangon, transfer to the Hotel. Lunch in the hotel. In the afternoon orientation tour of the city ending with the visit of the most enchanting and spectacular Pagoda of Myanmar: the Shwedagon. Overnight Yangon

RANGOON (YANGON) – BAGAN (BY FLIGHT) (B/-/-)

Early morning transfer to the airport. Flight to Bagan and transfer to the Ayar jetty. Embark to ship.

Post: Heho Extension & Yangon Stopover (3N/4D) from US\$ 860 per person

MANDALAY - HEHO - INLE LAKE (-/L/D)

After disembarkation, transfer to airport for flight to Heho. Transfer from the Heho airport to the hotel by the lake shore. Inle Lake, located 900 meters above sea level surrounded by beautiful mountains of the Shan plateau, is the home land of the Inthar tribe famous not only for their unique leg-rowing style and fishing method but also for the floating gardens used as vegetable plantations. If by chance today coincides with the market day, we will visit the regional market which is held on a 5 days rotation basis in different areas of the Lake. We will visit Phaungdawoo Pagoda – famous for its richly gilded five small Buddha images; Ngaphechaung monastery (also known as jumping cat monastery) was built more than one and a half century ago and features a number of interesting old Buddha Images; silk and cotton weaving cottages and black smith. Overnight at Inle

INLE - INDEIN (B/L/D)

We explore the southern part of the Lake by boat sailing through small twisting and turning creeks to reach Indein village. This small village located on the southwestern bank of the lake is famous for its ruined clusters of pagodas dated back to 16th century. The tranquil peaceful ambience and the ruins overgrown with bushes will bring you centuries back.

Ywa-Ma village, gold and silver smiths workshop. In the evening, enjoy the sunset while visiting the Inle Lake by boat. Overnight at Inle

HEHO-YANGON & YANGON FULL DAY SIGHTSEEING (B/L/D)

Breakfast at the hotel. Transfer to the airport to take the flight to Yangon. Upon arrival to Yangon, The full day tour of Yangon commences with a visit to city center and Sule Pagoda, the landmark of downtown Yangon, followed by Chaukhtatgyi, the colossal reclining Buddha, followed by photographing at Kandawgyi (Royal) Lake.

Afternoon sightseeing includes Bogyoke Market (formerly called Scott Market), where we can shop varieties of goods ranging from handicrafts to clothing and local food/ snack, antique, jewellery shops, art galleries, and clothing; sightseeing and visit at Botahtaung Pagoda. If time permits, we will a walk at Chinatown area, the bustle point of Yangon.

Overnight Yangon

Remark: Bogyoke Market closes on Monday & public holidays.

DEPARTURE FROM YANGON (B/-/-)

Breakfast at the hotel. Transfer to the airport for Departure Yangon.



NEW ROYAL MYANMAR (3N)

Pre: Yangon stopover with Bagan (4N/5D) from US\$ 880 per person

RANGOON (YANGON) (L/D)

Arrive Yangon International airport. You will be transferred to your hotel by your tour guide who meet and greet you at the airport. Free at leisure for the rest of the day.

RANGOON (YANGON) FULL DAY SIGHTSEEING (B/L/D)

Breakfast at the hotel. The full day tour of Yangon commences with a visit to city center and Sule Pagoda, the landmark of downtown Yangon, followed by a short walk to the Strand hotel, a relic of the colonial-era legacy which was opened in 1901 by the famed Sakies brothers; Chaukhtatgyi, the colossal reclining Buddha, followed by photographing at Kandawgyi (Royal) Lake.

Afternoon sightseeing includes Bogyoke Market (formerly called Scott Market), where we can shop varieties of goods ranging from handicrafts to clothing and local food/ snack; sightseeing and sunset viewing at Shwedagon Pagoda, an inspiring golden stupa which is one of the best landmarks in Myanmar. If time permits, we will a walk at Chinatown area, the bustle point of Yangon.

Remark: Scott Market closes on Monday and Public Holidays.

YANGON / BAGAN (BY FLIGHT) (B/L/D)

Drive to the airport for the early morning flight to Bagan. visit Myinkaba Gubyaukkyi Temple, a typical Mon style temple; Manuha Temple, a captured king's impression of life in prison; Nanpaya Temple; an earliest masterpiece with its fine stone carvings; photo stop at Seinnyet Nyima Pagodas, a temple and a stupa with exquisite design and Mingala zedi pagoda, on of the last ones built in pagan .Sunset from a small Hill/High Platform/ some Vantage point in Bagan. Overnight in Bagan.

BAGAN SIGHTSEEING (B/L/D)

Morning sightseeing begins with visit to the Nyaung Oo Market; Shwezigon Pagoda, the prototype of later Myanmar stupas; Wetkyi-in Gubyakkyi Temple, with fine mural paintings of jataka scenes; Htilominlo Temple, noted for its plaster carvings and visit lacquerware factory. Afternoon excursion to Ananda Temple, an architectural masterpiece resembling a Greek Cross; and Thatbyinnyu, the highest of Bagan Temples ; and Bypaya, a Pyu style pagoda on the brink of the majestic Ayeyarwaddy River. Overnight in Bagan.

BAGAN (EMBARKATION) (B/-/-)

Some more visits or shopping and then drive to Bagan Ayar jetty.

Post: Mandalay, Pyin Oo Lwin & Inle Lake Package (5N/6D) from US\$ 1,230 per person

SAGAING (DISEMBARKATION) (B/L/D)

Disembarkation at Sagaing and we'll visit to Amarapura, former Royal capital of Myanmar but the suburb of Mandalay nowadays. Highlights include Mahargandaryone monastery, a typical monastic school; U Bein bridge, the world's longest teak wood bridge across the Taungthamanlake, an ideal place to view the sunset also; and silk weaving factory. Overnight Mandalay

MANDALAY – PYIN OO LWIN - MANDALAY (B/L/D)

Breakfast at the hotel. Drive to PyinOoLwin, formerly called Maymyo, a hill station established just after the British annexation, is about 68 km east of Mandalay (about two hours drive). Sightseeing highlights include National Kandawgyi Garden (formerly known as botanical garden) – a forest reserve and well maintained garden on totaling 437 acres of land; Pwekauk fall – a unique place for relaxing and having a picnic; Chinese Temple and local market.

Taking the horse cart along the streets of the town to view the old colonial buildings is another unique experience. Return to Mandalay.

MANDALAY (B/L/D)

Breakfast at the hotel. We'll visit Mandalay, the last capital of Myanmar kingdom, includes Mahamuni Buddha Image – believed to be cast in bronze in front of Buddha himself and nowadays gilded with thick gold leaf; gold leaf hammering, marble carving, and tapestry making.

Afternoon sightseeing includes Shwenandaw monastery, still existing masterpiece of last Myanmar kingdom's architecture in teak and wood carving; Kuthodaw Pagoda, renowned as the world's largest book; and Mandalay Hill, regarded a natural watch tower in the plain region of Mandalay, to view the sunset. Overnight at Mandalay

MANDALAY – HEHO – INLE (-/L/D)

After breakfast at hotel, transfer to airport for flight to Heho. Transfer from the Heho airport to the hotel by the lake shore. Inle Lake, located 900 meters above sea level surrounded by beautiful mountains of the Shan plateau, is the home land of the Inthar tribe famous not only for their unique leg-rowing style and fishing method but also for the floating gardens used as vegetable

plantations. If by chance today coincides with the market day, we will visit the regional market which is held on a 5 days rotation basis in different areas of the Lake. We will visit Phaungdawoo Pagoda – famous for its richly gilded five small Buddha images; Ngaphechaung monastery (also known as jumping cat monastery) was built more than one and a half century ago and features a number of interesting old Buddha Images; silk and cotton weaving cottages and black smith. Overnight at Inle

INLE - INDEIN (B/L/D)

We explore the southern part of the Lake by boat sailing through small twisting and turning creeks to reach Indein village. This small village located on the southwestern bank of the lake is famous for its ruined clusters of pagodas dated back to 16th century. The tranquil peaceful ambience and the ruins overgrown with bushes will bring you centuries back.

Ywa-Ma village, gold and silver smiths workshop. In the evening, enjoy the sunset while visiting the Inle Lake by boat. Overnight at Inle

HEHO / YANGON (BY FLIGHT) – DEPARTURE (B/L/-)

In the morning drive to airport and return back to Yangon. If time permits, visit Sule paya and the City Centre for shopping before the International flight departure.



From Royal Mandalay to Ancient Bagan (2N)

Pre: Yangon stopover with Mandalay (2N/3D) from US\$ 570 per person

YANGON (ARRIVAL) (L/D)

Arrive at the Yangon International Airport. Afternoon, excursion to Chaukhtatgyi Reclining Buddha and Shwe Dagon Pagoda, one of the wonders of the world and the most venerated Buddhist Monument in Myanmar, where one can see the lifestyle of Myanmar People. Overnight in Yangon.

YANGON - MANDALAY (BY FLIGHT) (B/L/D)

Transfer to airport for the flight to Mandalay, the last capital of Myanmar Monarchs. Excursion to Ancient Capital Amarapura, 11 Kilometers south of Mandalay visiting Mahagandayon monastery; 1.2 kilometer long U Bein Wooden Bridge and silk-weaving factory. Afternoon visit Maha Muni Buddha Image and continue to Shwe Kyaung, a monastery once King Mindon's royal palace apartment for meditation and end up the day while enjoying the sunset from the Mandalay Hill, a vantage point for the panoramic view of Mandalay. Overnight in Mandalay.

AVA - MANDALAY (Embark) (B/-/-)

In the morning you cross the Myitnge River with a ferry boat to reach the ancient capital Ava. The sightseeing in horse-cart includes Maenu brick monastery, ancient Bargayar monastery famous for its

hundreds of teak pillars, the wood carving and Nan Myint tilting watch tower. Drive to Gawein Jetty to board the ship at 12.30 hrs.

Post: Bagan stopover (3N/4D) from US\$ 765 per person

BAGAN (-/L/D)

Passenger will disembark at Aye Yar Jetty. Afternoon visit Myinkaba Gubyaukkyi Temple, a typical Mon style temple; Manuha Temple, a captured king's impression of life in prison; Nanpaya Temple; an earliest masterpiece with its fine stone carvings; photo stop at Seinnyet Nyima Pagodas, a temple and a stupa with exquisite design and Mingala zedi pagoda, on of the last ones built in pagan .Sunset from a small Hill/High Platform/ some Vantage point in Bagan. Overnight in Bagan.

BAGAN (B/L/D)

Morning sightseeing begins with visit to the Nyaung Oo Market; Shwezigon Pagoda, the prototype of later Myanmar stupas; Wetkyi-in Gubyakkyi Temple, with fine mural paintings of jataka scenes; Htilominlo Temple, noted for its plaster carvings and visit lacquerware factory. Afternoon excursion to Ananda Temple, an architectural masterpiece resembling a Greek Cross; and Thatbyinnyu, the highest of Bagan Temples ; and Bypaya, a Pyu style pagoda on the brink of the majestic Ayeyarwaddy River. Overnight in Bagan.

BAGAN - YANGON (By FLIGHT) (B/L/D)

Morning flight back to Yangon. Afternoon visit Sule Paya, Yangon City centre and shopping. Overnight in Yangon.

YANGON (DEPARTURE) (B/-/-)

Transfer to Yangon International Airport for the International Departure Flight.



Between Ancient Bagan & Royal Mandalay (2N)

Pre: Yangon stopover (2N/3D) from US\$ 580 per person

YANGON ARRIVAL (L/D)

Arrive at the Yangon International Airport. Afternoon, excursion to Chaukhtatgyi Reclining Buddha and Shwe Dagon Pagoda, one of the wonders of the world and the most venerated Buddhist Monument in Myanmar, where one can see the lifestyle of Myanmar People. Overnight in Yangon.

YANGON / BAGAN (BY FLIGHT) (B/L/D)

Drive to the airport for the early morning flight to Bagan. Siteseeing begins with visit to the Nyaung Oo Market; Shwezigon Pagoda, the prototype of later Myanmar stupas; Wetkyi-in Gubyakkyi Temple with fine mural paintings of jataka scenes; Htilominlo Temple, noted

for its plaster carvings and visit lacquerware factory. Afternoon visit begins with Ananda Temple, an architectural masterpiece resembling a Greek Cross; Thatbyinnyu , the highest of Bagan temples; Mingalarzedi Pagoda; for the panoramic view of the valley of temples and pagodas, sunset from a small Hill/High Platform/ some Vantage point in Bagan. Overnight in Bagan.

BAGAN (EMBARKATION) (B/-/-)

Some more visits or shopping and then drive to Bagan Ayar jetty at 11.30 to board the ship.

Post: Beyond Mandalay with Monwya, Heho, Pindaya, Inle Stopover (7N/8D) from US\$ 1,515 per person

MANDALAY – AVA (-/L/D)

All passengers will disembark at Sagaing Jetty (Thursday only) or Gawein jetty (Sunday Only) at around 09.30/10.00 hrs. In the afternoon you cross the Myitnge River with a ferry boat to reach Ancient Capital Ava. The siteseeing in horse-cart includes Maenu brick monastery, ancient Bargayar monastery famous for its hundreds of teak pillars and the wood curving and Nan Myint tilting watching tower. Overnight in Mandalay.

MANDALAY / MINGUN / MANDALAY (BY BOAT) (B/L/D)

Excursion to Mingun, a village on the western bank of Ayeyarwaddy River. Tour highlights include Settawya Pagoda with a marble foot print of Buddha; Pondawypaya, nearby the river; Pahtodawgyi, an enormous pile of bricks is all that remains of King Bodawpaya's grandiose scheme; Mingun Bell, the world's largest ringing bell weighing 90 tons; Mingun Village; and Shinbume Pagoda, most attractive pagoda built in 1816 by King Bodawpaya's grandson in memory of one of his wives. Afternoon Mandalay tour includes Mahamuni Pagoda; Shwenandaw Monastery, noted for its exquisite wood carvings; Kuthodaw Pagoda, known as the world's Biggest Book for its stone slabs of Buddhist scriptures; and Mandalay Hill, advantage point for panoramic view of the city. Overnight in Mandalay.

MANDALAY / AMARAPURA/ SAGAING / MONWYA (BY CAR) (B/L/D)

Morning excursion to Ancient Capital Amarapura, 11 Kilometers south of Mandalay visiting Mahagandayon monastery; 1.2 Kilometer long U Bein Wodden Bridge and visit handicraft workshop. Afternoon drive to Sagaing crossing the Inwa (Ava) Bridge on the Ayeyarwaddy River. Tour highlights are Ywataung Village, silver smith workshop and Sagaing Hills, a retreat for Buddhist devotees with numerous pagodas and monasteries. Then transfer to Monywa, on the eastern bank of Chindwin River, about 136 kilometers to the west of Mandalay, and the land route journey is about 3hrs drive. Overnight in Monywa. Lunch at Local Restaurant Dinner at Hotel

MONWYA / MANDALAY (BY CAR) (B/L/D)

Morning visit Pho win hill, on the other bank of the Chindwin river, Than Boddhay temple , The reclining Buddha. In the evening drive back to Mandalay. Overnight in Mandalay.

MANDALAY/ HEHO / PINDAYA (BY FLIGHT/CAR) (B/L/D)

Morning flight to Heho in the Shan State known for its colourful markets, scenery, country sides and especially its people, a mixture of tribal races. Drive from Heho airport to Pindaya, a small quite town, enjoying scenic beauty along the country side. Evening excursion of the town, visiting the lake and the Pindaya Cave , well known for its countless Buddha Images. Overnight in Pindaya.

PINDAYA / INLE (BY CAR) (B/L/D)

In the morning drive to Inle Lake, 100km from Pindaya. Escursion of

the lake well known for its scenic beauty and its unique leg rower. Tour highlights include Phaung Daw Oo Pagoda; wonderful floating gardens; floating market on its market day; native method of fishing; traditional weaving villages; and village life in the lake. (Please note that the floating market is once every 5 days, but may vary according to the Buddhist Sabathdays). Overnight in Inle Lake.

INLE – HEHO (BY CAR) & HEHO- YANGON (BY FLIGHT) (B/L/D)
Drive to Heho airport for the flight to Yangon. Afternoon visit Sule Pagoda and the City Centre. Overnight in Yangon.

YANGON DEPARTURE (B/-/-)
International departure flight.



Between Royal Mandalay & Ancient Bagan (1N)

Pre: Yangon & Mandalay Stopover (2N/3D) from US\$ 555 per person

YANGON (ARRIVAL) (L/D)
Arrive at the Yangon International Airport. Afternoon, excursion to Chaukhtatgyi Reclining Buddha and Shwe Dagon Pagoda, one of the wonders of the world and the most venerated Buddhist Monument in Myanmar, where one can see the lifestyle of Myanmar People. Overnight in Yangon.

YANGON - MANDALAY (BY FLIGHT) (B/L/D)
Transfer to airport for the flight to Mandalay, the last capital of Myanmar Monarchs. Excursion to Ancient Capital Amarapura, 11 Kilometers south of Mandalay visiting Mahagandayon monastery; 1.2 kilometer long U Bein Wooden Bridge and silk-weaving factory. Afternoon visit Maha Muni Buddha Image and continue to Shwe Kyaung, a monastery once King Mindon's royal palace apartment for meditation and end up the day while enjoying the sunset from the Mandalay Hill, a vantage point for the panoramic view of Mandalay. Overnight in Mandalay.

SAGAING (Embark) (B/-/-)
Breakfast at the hotel. Drive to SAGAING Jetty at 10.00 hrs.

Post: Bagan & Mandalay Stopover (3N/4D) from US\$ 765 per person

BAGAN (-/L/D)
Passenger will disembark at Aye Yar Jetty. Afternoon visit Myinkaba Gubyaukkyi Temple, a typical Mon style temple; Manuha Temple, a captured king's impression of life in prison; Nanpaya Temple; an earliest masterpiece with its fine stone carvings; photo stop at Seinnyet Nyima Pagodas, a temple and a stupa with exquisite design and Mingala zedi pagoda, on of the last ones built in pagan .Sunset from a small Hill/High Platform/ some Vantage point in Bagan. Overnight in Bagan.

BAGAN (B/L/D)
Morning sightseeing begins with visit to the Nyaung Oo Market;

Shwezigon Pagoda, the prototype of later Myanmar satupas; Wetkyi-in Gubyakkyi Temple, with fine mural paintings of jataka scenes; Htilominlo Temple, noted for its plaster carvings and visit lacquerware factory. Afternoon excursion to Ananda Temple, an architectural masterpiece resembling a Greek Cross; and Thatbyinnyu, the highest of Bagan Temples ; and Bypaya, a Pyu style pagoda on the brink of the majestic Ayeyarwaddy River. Overnight in Bagan.

BAGAN - YANGON (By FLIGHT) (B/L/D)
Morning flight back to Yangon. Afternoon visit Sule Paya, Yangon City centre and shopping. Overnight in Yangon.

YANGON (DEPARTURE) (B/-/-)
Transfer to Yangon International Airport for the International Departure Flight.



Grand Voyage Of The Chindwin River (10N)

Pre: Yangon Stopover with Bagan (2N/3D) from US\$ 580 per person

RANGOON (YANGON) (L/D)
International arrival to Yangon, transfer to the Hotel. In the afternoon orientation tour of the city ending with the visit of the most enchanting and spectacular Pagoda of Myanmar: the Shwedagon. Overnight at Yangon

RANGOON(YANGON) – BAGAN (BY FLIGHT) (B/L/D)
Early morning transfer to the airport. Flight to Bagan, one of the Asia's most important archaeological sites and one out of two most eminent religious old cities in South East Asia. The sightseeing starts with a visit to Nyaung Oo market – a typical local market; followed by visits to most distinctive pagodas such as Shwezigon Pagoda – the holiest one believed to be enshrined with Buddha tooth and hair; Gubyaukgyi Temple(Wetkyiinn village) – the 13th century 'cave temple' with fine frescoes of scenes from Jatas; Anada Temple –one of the masterpieces surviving and remaining in Bagan and considered to be in the Mon architecture style.Afternoon, we will visit a lacquer ware factory followed by a visit to local village. sunset from a small Hill/High Platform/ some Vantage point in Bagan. Overnight in Bagan.

BAGAN (EMBARK THE SHIP) (B/-/-)
Transfer to the Bagan Ayar Jetty.

Post: Yangon Stopover (1N/2D) from US\$ 370 per person

MANDALAY – YANGON (BY AFTERNOON FLIGHT) (-/L/D)
Flight to Yangon. Overnight at Yangon

YANGON – DEPARTURE (B/-/-)
Visit Sule Paya and Colonial downtown. International departures.

GENERAL INFORMATION

Suggested Attire

Aboard the Irrawaddy Explorer, attire is casual and comfortable during the day, with resort-style clothing, and comfortable, but sturdy, footwear for excursions.

On occasion, we will visit religious sites that may require long pants and covered shoulders. In this instance, our shipboard staff will notify you the day prior, to allow you to plan accordingly.

Evening wear consists of open-neck shirts, trousers, skirt, or similar attire. Footwear is always required in all public areas, and when navigating stairs on board.

Communication

E-mail/internet is available in all public areas of the vessel, free-of-charge for passengers that bring their own WiFi-capable devices.

Although the vessel does not offer direct-dial calls from their suites while on board, in the event of an emergency, the Reception Desk can facilitate an international call, and associated costs will be billed to the guest's on-board account.

The RV Paukan 2015 contact information will be included in final travel documents, and may be provided as a contact number in the event of an emergency at home.

Onboard Account & Currency

The official currency on board is the US Dollar. All charges for services and products on board will be placed on the guest's shipboard account to be settled at the end of the voyage. MasterCard, Visa and US dollars are also accepted for the settlement of guest accounts.

Dietary Requirements

Our culinary team will make every effort to accommodate special dietary requests. Please inform our office at least 60 days prior to departure of these requests.

Electricity

The electrical current on board is 220V. For those items that are dual voltage, suites are outfitted with a multi-plug configuration feature. Guests should be sure to bring the appropriate converter for devices that are not dual voltage.

Fitness Centre

The RV Paukan 2015 is equipped with state-of-the-art fitness equipment. Guests may enjoy panoramic views of the Irrawaddy River while enjoying the Fitness Center, located on the Sun Deck.

Gratuities

Gratuities are a personal matter, and are a token of your appreciation for a job well done. Envelopes will be provided en-suite on the last night of your sailing. US dollars are the preferred currency, however guests may also charge gratuities on their shipboard account, which may be settled with a credit card at the end of the voyage. Suggested gratuities are \$10 per person per day for shipboard staff and crew, \$6 per person per day for tour guides, and \$3 per person per day for Cruise Director.

Laundry Service

Twenty-four hour, professional laundry and pressing service is provided on board. Costs will be listed in each suite's directory, and charged to the guest's account.

Mail

Our Reception Desk staff would be pleased to mail postcards upon request. Applicable postage costs will be charged to the guest's account.

Medical Services

The RV Paukan 2015 staff is trained in first aid, and we are never far from on-shore medical services. Guests requiring oxygen for medical reasons are welcome to bring their own equipment, as required. Guests must bring the appropriate electric converter for personal medical equipment.

Pets

Unfortunately, we are unable to accommodate pets of any kind aboard the RV Paukan 2015.

Spa Services

The Paukan Spa offers a range of spa treatments from well-trained, professional, spa staff. A menu of services is available on board, and all costs associated with spa services will be charged to the guest's account.

Shore Excursions

All shore excursions during your 9-night cruise aboard the Irrawaddy Explorer are included in your cruise tariff.

Excursions are led by expert guides, and guests are divided into two groups, guaranteeing there are never more than 28 passengers touring together. Electronic listening devices are complimentary to all guests in order to ensure that guests are able to hear their guides, even in crowded areas.

Smoking

The comfort and safety of our guests is our first priority. Smoking is not permitted in the suites or enclosed, public areas on board. There is a designated smoking area on the Sun Deck.

Special Occasions

We are excited to celebrate our guests' special moments. Please notify us at least 60 days prior to departure of any special occasions during the voyage.

Valuables

All suites are equipped with a personal, electronic safe. Paukan Cruises is not responsible for valuables brought on board. Further details are provided within our Terms & Conditions.

Visitors on Board/Security

Only guests who possess tickets for passage are allowed on board the RV Paukan 2015. Security services are provided on board to ensure everyone's safety throughout the journey.





RV PAUKAN
2 0 0 7
A Charming Cruising Boutique Hotel

RV PAUKAN
2 0 1 2
A Small Cruising Boutique Hotel

WWW.AYRAVATACRUISES.COM